

Orbit Couplings – Pipe Repair Clamps

Product Brochure

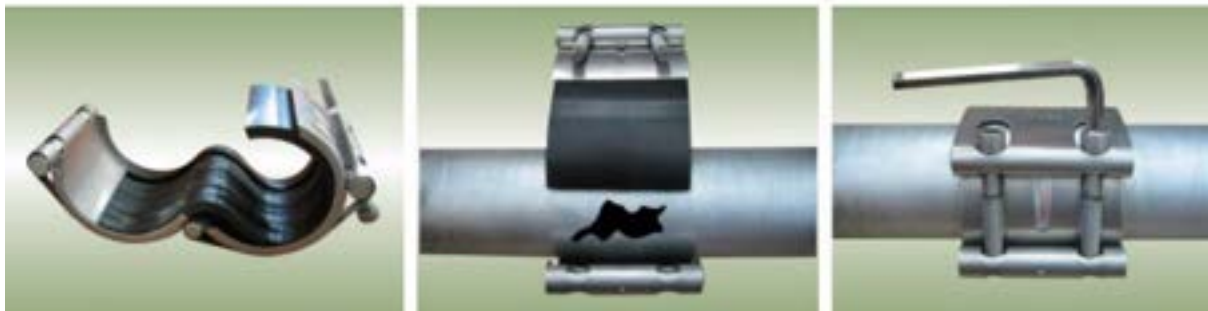

Pipe Repair Clamps are installed to seal leaking pipes, by wrapping the repair clamp around the damaged pipe, and tightening the bolts.



Distributed in Australia by Dewater Products Pty Ltd

Email: Sales@dewaterproducts.com.au



Example 1



Example 2



Example 3



Example 4

Orbit Couplings – Pipe Repair Clamps



Pipe Repair Clamps to suit the outside diameter size of your pipes.

Fast and easy to install, stop leaking pipes by installing Orbit Pipe Repair Clamps.

Distributed in Australia by Dewater Products Pty Ltd. E-mail: Sales@dewaterproducts.com.au



Model: ORBIT REPAIR CLAMP Series 1

1. Available in different length options 200mm, 300mm, 400mm.
2. Repair Burst Pipes Quickly and Cheaply
3. Opens via flexible casing, for easy installation
4. 100% Tight seal for temporary repair
5. Good for repairing Metal, PE, FRP, GRP, PVC pipe
6. 316 Stainless Steel Casing with EPDM or NBR seal. Viton on request.

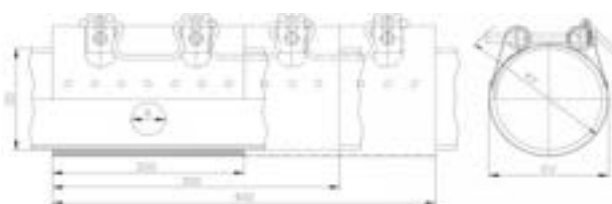
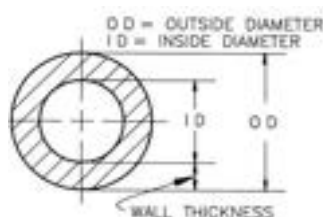

Size	OD	OD Range		200mm Length	300mm Length	400mm Length	Maximum Bolt Tightness	Pressure	Estimated weight
(mm)	(mm)	(mm)		(mm)	(mm)	(mm)	(Nm)	Bar	(Kg)
44.0	44.0	44-48		200	300	n/a	15	16	0.7
48.0	48.0	48-52		200	300	n/a	15	16	0.8
54.0	54.0	54-58		200	300	n/a	30	16	1
60.3	60.3	58-62		200	300	n/a	30	16	1.2
67.0	67.0	67-71		200	300	n/a	30	16	1.3
70.0	70.0	68-72		200	300	n/a	30	16	1.4
75.0	75.0	73-77		200	300	n/a	50	16	1.5
82.0	82.0	80-84		200	300	400	50	16	1.7
87.0	87.0	86-90		200	300	400	50	16	1.8
88.9	88.9	88-92		200	300	400	50	16	1.8
95.0	95.0	95-99		200	300	400	50	16	1.9
110.0	110.0	108-112		200	300	400	50	16	1.9
114.3	114.3	113-117		200	300	400	50	16	2
168.3	168.3	167-171		200	300	400	80	16	6
219.1	219.1	219-223		200	300	400	100	16	8
273.0	273.0	273-277		200	300	400	100	10	9
315.0	315.0	315-319		n/a	300	400	100	10	9
323.9	323.9	323-327		n/a	300	400	100	10	10

Available in sizes up to 330.0mm

Any OD size can be manufactured between 44.0mm and 330.0mm





Model: ORBIT REPAIR CLAMP Series 2

1. Available in different length options 200mm, 300mm, 400mm.
2. Repair Burst Pipes Quickly and Cheaply
3. Opens into two halves with a 2 part casing, for easy installation
4. 100% Tight seal for temporary repair
5. Good for repairing Metal, PE, FRP, GRP, PVC pipe
6. 316 Stainless Steel Casing with EPDM or NBR seal. Viton on request.

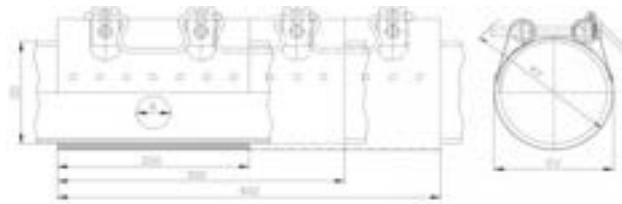
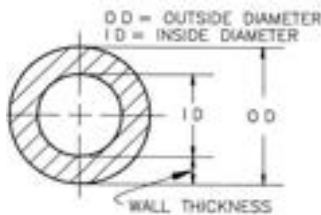

Size (mm)	OD (mm)	OD Range (mm)	200mm Length (mm)	300mm Length (mm)	400mm Length (mm)	Maximum Bolt Tightness (Nm)	Pressure (Bar)	Estimated weight (Kg)
88.0	88.0	88-101	200	n/a	n/a	50	16	1.8
100.0	100.0	100-113	200	n/a	n/a	50	16	1.9
110.0	110.0	110 - 123	200	300	400	50	16	1.9
120.0	120.0	120 - 133	200	300	400	50	16	2
159.0	159.0	159 - 172	200	300	400	80	16	6
190.0	190.0	190 - 203	200	300	400	80	16	8
210.0	210.0	210 - 223	200	300	400	100	16	8
220.0	220.0	220 - 233	200	300	400	100	16	8
240.0	240.0	240 - 253	200	300	400	100	16	9
269.0	269.0	269 - 282	200	300	400	100	10	10
282.0	282.0	282 - 295	200	300	400	100	10	10
315.0	315.0	315 - 328	200	300	400	100	10	11
347.0	347.0	347 - 360	n/a	300	400	100	6	11
365.0	365.0	365 - 378	n/a	n/a	400	100	5	11
390.0	390.0	390 - 403	n/a	n/a	400	100	5	12
405.0	405.0	405 - 418	n/a	n/a	400	100	5	12
427.0	427.0	427 - 440	n/a	n/a	400	100	5	13

Available in sizes up to 440.0mm

Any OD size can be manufactured between 88.0mm and 440.0mm





Pipe Coupling model: Flex Grip - Open

1. Available in S or L, short or long versions
2. Easily installed on pipes already in place
3. Opens with a hinge, for easy installation
4. 100% Tight seal for temporary repair
5. Good for repairing Metal, PE, FRP, GRP, PVC pipe
6. 316 Stainless Steel Coupling with EPDM, NBR seal

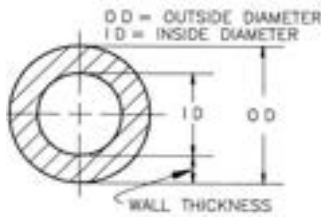

VITON or SILICONE

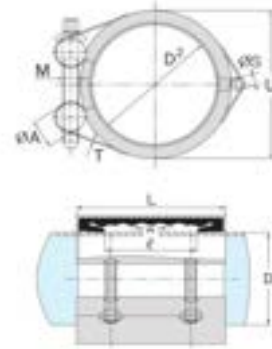

Higher Bar pressures available

OD	Pipe OD Range	Short length	Long Length	Pipe Gap (w) Short	Pipe Gap (w) Long	Maximum Bolt Tightness	Pressure	Estimated weight
(mm)	(mm)	(mm)	(mm)	(mm)	(mm)	(Nm)	Bar	(Kg)
21.3	19-23	57		5	n/a	15	32	0.35
26.9	24.9-28.9	57		5	n/a	15	32	0.4
33.7	31.7-35.7	57		5	n/a	15	32	0.5
42.2	38-44	57		5	n/a	15	32	0.6
48.3	46-50	57	100	5	30	30	32	0.65
60.3	58-62	80	139	5	15	30	32	1.4
73.0	71-75	80	139	5	30	30	32	1.5
88.9	87-91	107	203	5	30	50	28	3
114.3	104-118	107	203	5	30	50	28	3.3
141.3	139-143	116	203	5	30	80	28	3.3
168.3	166-170	116	203	5	40	80	24	5.1
219.1	217-221	155	255	10	40	100	16	11.8
273.3	271-275	155	255	10	40	100	16	13.1
323.9	322-326	155	255	10	40	100	14	13.5
355.6	353-357	155	255	10	40	100	14	18.2

Flex Grip 2 model available in sizes up to 4000.0mm

Any OD size can be manufactured





Pipe Coupling model: FLEX GRIP 2

2 Part Casing Design, Opens into 2 halves

1. Available in S - short length, or L - long length models
2. Non-axially restrained Pipe Coupling, and can also be used as a Pipe Repair Clamp.
3. Allows slight misaligned pipe connection, increased tolerance when installing
4. Allows vibration in the pipeline and slight movement, increased sealing strength
5. Good for connecting Metal, PE, FRP, GRP, PVC and rubber lined pipes
6. 316 Stainless Steel Casing with EPDM, NBR, VITON or SILICONE seal options

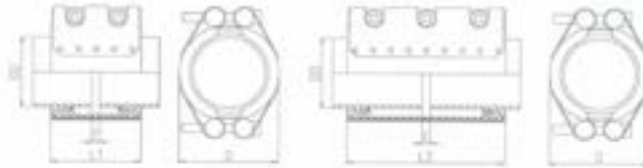
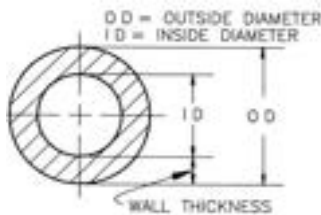

Higher Bar pressures available

OD	Pipe OD Range	Short length	Long Length	Pipe Gap (R) Short	Pipe Gap (R) Long	Maximum Bolt Tightness	Pressure	Estimated weight
(mm)	(mm)	(mm)	(mm)	(mm)	(mm)	(Nm)	Bar	(Kg)
42.4	42-44	57	100	5	15	15	32	0.8
48.3	47-49	57	100	5	15	15	32	0.85
60.3	59-62	80	139	5	15	30	32	1.8
73.0	72-74	80	139	5	30	30	32	1.9
88.9	88-92	107	203	5	30	30	28	3.9
114.3	112-116	107	203	5	30	50	28	4.3
141.3	139-143	116	203	5	30	50	28	6.5
168.3	166-170	116	203	10	40	50	24	7.1
219.1	217-221	155	255	10	40	80	16	15.3
273.0	271-275	155	255	10	40	100	16	16.3
323.9	322-326	155	255	10	40	100	16	20.1
355.6	353-357	155	255	10	40	100	14	22.9
406.4	404-408	155	255	10	40	100	12	24
457.2	455-459	155	255	10	40	120	12	25.8
508.0	506-510	155	255	10	40	120	10	26.5
558.8	556-560	155	255	10	40	120	9	28
609.6	607-611	155	255	10	40	120	8	30
711.2	709-713	155	255	10	40	120	7	32

More sizes available up to 4000.0mm

Any OD size can be manufactured

www.orbitcouplings.com.au



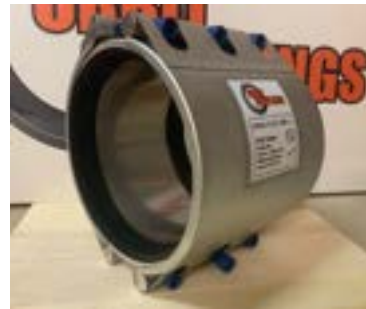

Pipe Coupling model: OPEN FLEX 200-L

1. 200mm Long - 2 piece casing opening pipe clamp, with 6 x bolts
2. Non-axially restrained Pipe Coupling, and can also be used as a Pipe Repair Clamp.
3. Allows a 60mm pipe gap with a stainless steel strip insert fitted.
4. Allows slight misalignment, vibration in the pipeline and slight flex movement
5. Good for connecting Metal, PE, FRP, GRP, PVC pipe
6. 316 Stainless Steel Coupling with EPDM, NBR, VITON or SILICONE seal

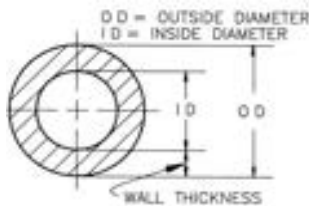

Features: 12mm OD range in all sizes
only available in OPEN FLEX 200-L model

OD	Pipe OD Range	Length	Pipe Gap R	Maximum Bolt Tightness	Pressure
(mm)	(mm)	(mm)	(mm)	(Nm)	Bar
154.0	148 - 160	200	60	60	25
168.3	162-174	200	60	60	25
180.0	174-186	200	60	80	25
219.1	213-225	200	60	80	20
273.0	267-279	200	60	100	20
323.9	317-329	200	60	100	16
355.6	349-361	200	60	100	16
406.4	400-412	200	60	100	12
457.2	451-463	200	60	100	12
508.0	502-514	200	60	120	12
558.8	552-564	200	60	120	8
609.6	603-615	200	60	120	8
711.2	705-717	200	60	150	6
762.0	756-768	200	60	150	6
812.8	806-818	200	60	150	6
914.4	908-920	200	60	150	4
1016	1010-1022	200	60	150	4
1117.6	1111-1123	200	60	150	4

Any OD size can be manufactured
between 154.0mm - 2010.0mm



www.orbitcouplings.com.au



Pipe Coupling model: OPEN FLEX 300-L

1. 300mm Long - 2 piece casing opening pipe clamp, with 6 x bolts
2. Non-axially restrained Pipe Coupling, and can also be used as a Pipe Repair Clamp.
3. Allows a 120mm pipe gap with a stainless steel strip insert fitted.
4. Allows slight misalignment, vibration in the pipeline and slight flex movement
5. Good for connecting Metal, PE, FRP, GRP, PVC pipe
6. 316 Stainless Steel Coupling with EPDM, NBR, VITON or SILICONE seal

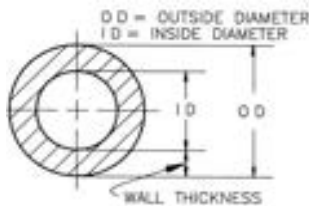

Higher Bar pressures available

OD	Pipe OD Range	Length	Pipe Gap R	Maximum Bolt Tightness	Pressure
(mm)	(mm)	(mm)	(mm)	(Nm)	Bar
219.1	217-221	300	120	100	20
273.0	271-275	300	120	100	20
323.9	320-327	300	120	100	18
355.6	352-359	300	120	100	18
406.4	403-409	300	120	100	14
457.2	454-460	300	120	100	14
508.0	505-512	300	120	100	14
558.8	555-562	300	120	100	12
609.6	606-613	300	120	100	12
711.2	707-715	300	120	100	10
762.0	758-766	300	120	100	10
812.8	809 - 817	300	120	100	10
914.4	910 - 918	300	120	100	10
1016	1012 -1020	300	120	100	10

Any OD size can be manufactured between 200.0mm - 1016.0mm

www.orbitcouplings.com.au





Pipe Coupling model: OPEN FLEX 300-LP

1. 300mm Long - 2 piece casing opening pipe clamp, with 6 x bolts
2. Non-axially restrained Pipe Coupling, and can also be used as a Pipe Repair Clamp.
3. Allows a 120mm pipe gap with a stainless steel strip insert fitted.
4. Allows slight misalignment, vibration in the pipeline and slight flex movement
5. Good for connecting Metal, PE, FRP, GRP, PVC pipe
6. 316 Stainless Steel Coupling with EPDM, NBR, VITON or SILICONE seal

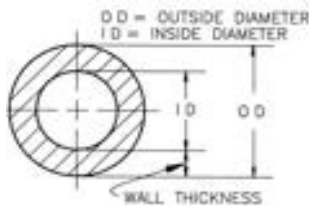

LP model is high pressure

OD	Pipe OD Range	Length	Pipe Gap R	Maximum Bolt Tightness	Pressure Rating
(mm)	(mm)	(mm)	(mm)	(Nm)	Bar
219.1	217-221	300	120	100	26
273.0	271-275	300	120	100	26
323.9	320-327	300	120	100	25
355.6	352-359	300	120	100	25
406.4	403-409	300	120	100	25
457.2	454-460	300	120	100	25
508.0	505-512	300	120	100	18
558.8	555-562	300	120	100	18
609.6	606-613	300	120	100	16
711.2	707-715	300	120	100	14
762.0	758-766	300	120	100	14
812.8	809 - 817	300	120	100	13
914.4	910 - 918	300	120	100	11
1016	1012 -1020	300	120	100	10

Any OD size can be manufactured between 219.1mm - 1016.0mm

www.orbitcouplings.com.au





Pipe Coupling model: OPEN FLEX 400-L

1. 400mm Long - 2 piece casing opening pipe clamp, with 8 x bolts
2. Non-axially restrained Pipe Coupling, and can also be used as a Pipe Repair Clamp.
3. Allows a 200mm pipe gap with a stainless steel strip insert fitted.
4. Allows slight misalignment, vibration in the pipeline and slight flex movement
5. Good for connecting Metal, PE, FRP, GRP, PVC pipe
6. 316 Stainless Steel Coupling with EPDM, NBR, VITON or SILICONE seal

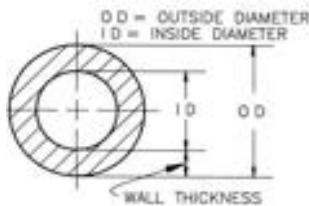

Higher Bar pressures available

OD	Pipe OD Range	Length	Pipe Gap R	Maximum Bolt Tightness	Pressure
(mm)	(mm)	(mm)	(mm)	(Nm)	Bar
219.1	217-221	400	200	100	20
273.0	271-275	400	200	100	20
323.9	320-327	400	200	100	18
355.6	352-359	400	200	100	18
406.4	403-409	400	200	100	14
457.2	454-460	400	200	100	14
508.0	505-512	400	200	100	14
558.8	555-562	400	200	100	12
609.6	606-613	400	200	100	12
711.2	707-715	400	200	100	10
762.0	758-766	400	200	100	10
812.8	809 - 817	400	200	100	10
914.4	910 - 918	400	200	100	10
1016	1012 -1020	400	200	100	10
1117.6	1113-1122	400	200	100	10
1219.2	1215-1224	400	200	100	8
1422.4	1418-1427	400	200	100	7
1524.0	1519-1529	400	200	100	5

Any OD size can be manufactured
between 200.0mm - 1524.0mm



www.orbitcouplings.com.au



ELBOW REPAIR CLAMP

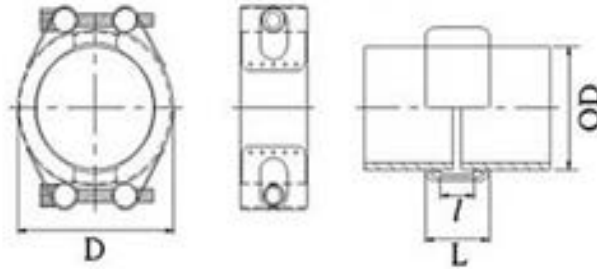

Pipe ND	Pipe OD		D (mm)	Coupling range (mm)	Working pressure (bar)		Length (mm)		Torque (Nm)	Bolt thread (M)
	(mm)	(inch)			Ship	Industry	L	l		
13A	15.8		34.0	15.3 ~ 17.0	17.5	40	27	8	7	6
15A	20.0		38.0	19.5 ~ 21.3	17.5	35	27	10	7	6
	21.7	1/2	39.0	21.0 ~ 23.0	17.5	35	27	10	7	6
20A	25.0		43.0	24.0 ~ 26.5	17.5	35	27	10	7	6
	27.2	3/4	45.0	26.0 ~ 28.5	17.5	35	27	10	7	6
	28.2		46.0	26.4 ~ 29.5	17.5	35	27	10	7	6
25A	30.0		48.0	29.0 ~ 31.5	17.5	35	27	10	7	6
	32.0		50.0	31.0 ~ 33.5	17.5	35	27	10	7	6
	34.0	1	52.0	33.0 ~ 35.5	17.5	35	27	10	7	6
32A	38.0		56.0	37.0 ~ 39.5	17.5	35	27	10	7	6
	40.0		58.0	39.5 ~ 41.8	17.5	35	27	10	7	6
	42.7	1 1/4	61.0	42.0 ~ 44.5	17.5	35	27	10	7	6
	44.5		62.5	44.0 ~ 46.5	17.5	35	27	10	7	6
40A	48.6	1 1/2	66.0	47.5 ~ 50.5	15	30	27	10	7	6
	50.8		68.8	49.2 ~ 51.5	15	30	27	10	7	6
50A	54.0		78.6	53.0 ~ 56.0	15	30	40	18	15	8
	57.0		81.6	56.0 ~ 59.0	15	30	40	18	15	8
	60.5	2	85.0	59.0 ~ 62.0	15	30	40	18	15	8
	63.0		87.6	62.0 ~ 65.0	15	30	40	18	15	8
65A	66.7		91.3	65.4 ~ 69.0	15	30	40	18	15	8
	69.0		93.6	68.0 ~ 72.0	15	30	40	18	15	8
	73.0		97.6	72.5 ~ 76.5	15	30	40	18	15	8
	76.3	2 1/2	101.0	75.0 ~ 79.0	15	30	40	18	15	8
80A	79.9		103.9	78.8 ~ 83.0	15	30	60	29	28	12
	84.0		108.0	82.5 ~ 86.0	15	30	60	29	28	12
	89.1	3	113.1	88.0 ~ 92.0	15	30	60	29	28	12
90A	101.6		125.6	100.0 ~ 104.0	15	30	60	29	28	12

Pipe ND	Pipe OD		D (mm)	Coupling range (mm)	Working pressure (bar)		Length (mm)		Torque	Bolt thread
	(mm)	(inch)			Ship	Industry	L	l	(Nm)	(M)
100A	104.0		128.0	102.0 ~ 106.0	12.5	25	60	29	28	12
	106.3		130.3	105.0 ~ 108.5	12.5	25	60	29	28	12
	108.0		132.0	106.0 ~ 110.0	12.5	25	60	29	28	12
	114.3	4	138.3	113.0 ~ 118.0	12.5	25	60	29	28	12
125A	127.0		151.0	125.0 ~ 129.5	9	18	60	29	28	12
	129.0		153.0	127.5 ~ 131.0	9	18	60	29	28	12
	133.0		157.0	131.0 ~ 135.5	9	18	60	29	28	12
	139.8	5	163.8	138.0 ~ 142.5	9	18	60	29	28	12
	141.3		165.3	139.5 ~ 144.0	9	18	60	29	28	12
150A	154.0		178.0	151.5 ~ 156.0	9	18	60	29	28	12
	159.0		183.0	156.0 ~ 161.0	9	18	60	29	28	12
	165.2	6	189.2	164.0 ~ 168.5	9	18	60	29	28	12
	168.3		192.3	166.0 ~ 170.5	9	18	60	29	28	12
175A	180.0		204.0	178.0 ~ 183.0	8	16	60	29	28	12
200A	200.0		225.0	198.0 ~ 203.5	8	16	61	29	40	12
	204.0		229.0	202.0 ~ 206.5	8	16	61	29	40	12
	216.3	8	241.3	214.0 ~ 219.0	8	16	61	29	40	12
	219.1		244.1	216.5 ~ 222.0	8	16	61	29	40	12
250A	254.0		279.0	251.0 ~ 257.0	8	16	61	29	40	12
	267.4	10	292.4	262.0 ~ 270.0	8	16	61	29	40	12
	273.1		298.1	270.0 ~ 277.0	8	16	61	29	40	12
300A	304.0		329.0	301.5 ~ 309.0	6.5	13	61	29	40	12
	318.5	12	343.5	316.0 ~ 323.0	6.5	13	61	29	40	12
	323.9		348.9	322.0 ~ 329.0	6.5	13	61	29	40	12
350A	355.6	14	380.6	352.0 ~ 361.0	6	12	61	29	40	12
400A	406.4	16	431.4	402.0 ~ 411.0	5.5	11	61	29	40	12
450A	457.2	18	482.2	453.0 ~ 460.0	5	10	61	29	40	12
500A	508.0	20	533.0	504.0 ~ 512.0	4.5	9	61	29	40	12

Universal Dual Clamp



Size range DN80 to DN300

PN16 rated - Pipe Repair Clamp, tested to PN24



Body: Ductile Iron, FBE Coated

Rubber Sleeve material options: EPDM/NBR

Fasteners: A2-70 (304SS)

DN	OD range	Length	Casing OD
80	88 – 99mm	225mm	219mm
100	107 – 119mm	225mm	246mm
150	157 – 171mm	225mm	291mm
200	219 – 226mm	310mm	352mm
250	270 – 276mm	310mm	420mm
300	320 – 328mm	310mm	471mm

Design features:

- **Two parts casing design, Heavy duty Ductile Iron, High strength and easy to install.**
- **A ribbed rubber sleeve design to maximise sealing effectiveness around the pipe.**

Pipe Materials: Steel Pipes, PVC and PE